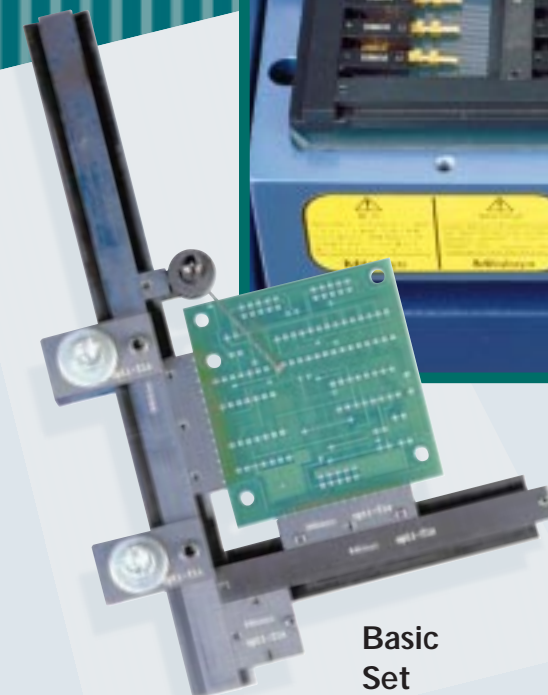

opti-fix

The Modular Mounting System for
Optical Measuring Devices

Basic
Set

- Highly flexible with few required parts
- Easy to Use
- Quickly Mounted
- Stable and Durable

High Flexibility and Measuring Accuracy with Surprisingly Few Parts

"opti-fix", the modular mounting system was developed specially for optical measuring technology. It guarantees secure positioning of the test piece during measuring and thus contributes to accurate results. Even sequential measurements are made easier.

All components are anodized with a matte black finish to eliminate all light reflections.

Mounting the securing elements on the measuring table is done either with a frame attached with a bracket, or using suction rail clips which can be attached to create a docking station at any position on the table.

Using surprisingly few parts, a wide variety of positions are readily available, and just as easily and quickly changed. The old familiar story of improvising with inappropriate tools has finally come to an end.

Advantages of "opti-fix"

- Easy and flexible fixing of thin and small workpieces
- Workpiece and x-y table will not become dirty, because clay and/or fixing tape are no longer necessary to fix the workpiece on a table. This fixture can be set on different types of x-y tables. Also, it is very easy and quick to replace and to position the workpiece on the table, which is most advantageous, when serial measurement is to be executed.
- Users can easily construct their own fixture by combination of 16 basic units.

Mitutoyo
www.mitutoyo.com

Mitutoyo America Corporation

New Jersey

18 Essex Road
Paramus, NJ 07652
Phone: (201) 368-0525
Fax: (201) 343-4969

Michigan

45001 Five Mile Road
Plymouth, MI 48170
Phone: (734) 459-2810
Fax: (734) 459-0455

Illinois

965 Corporate Blvd.
Aurora, IL 60504
Phone: (630) 978-5385
Fax: (630) 820-7403

California

16925 Gale Ave.
City of Industry, CA 91745
Phone: (626) 961-9661
Fax: (626) 333-8019

opti-fix

Basic Set

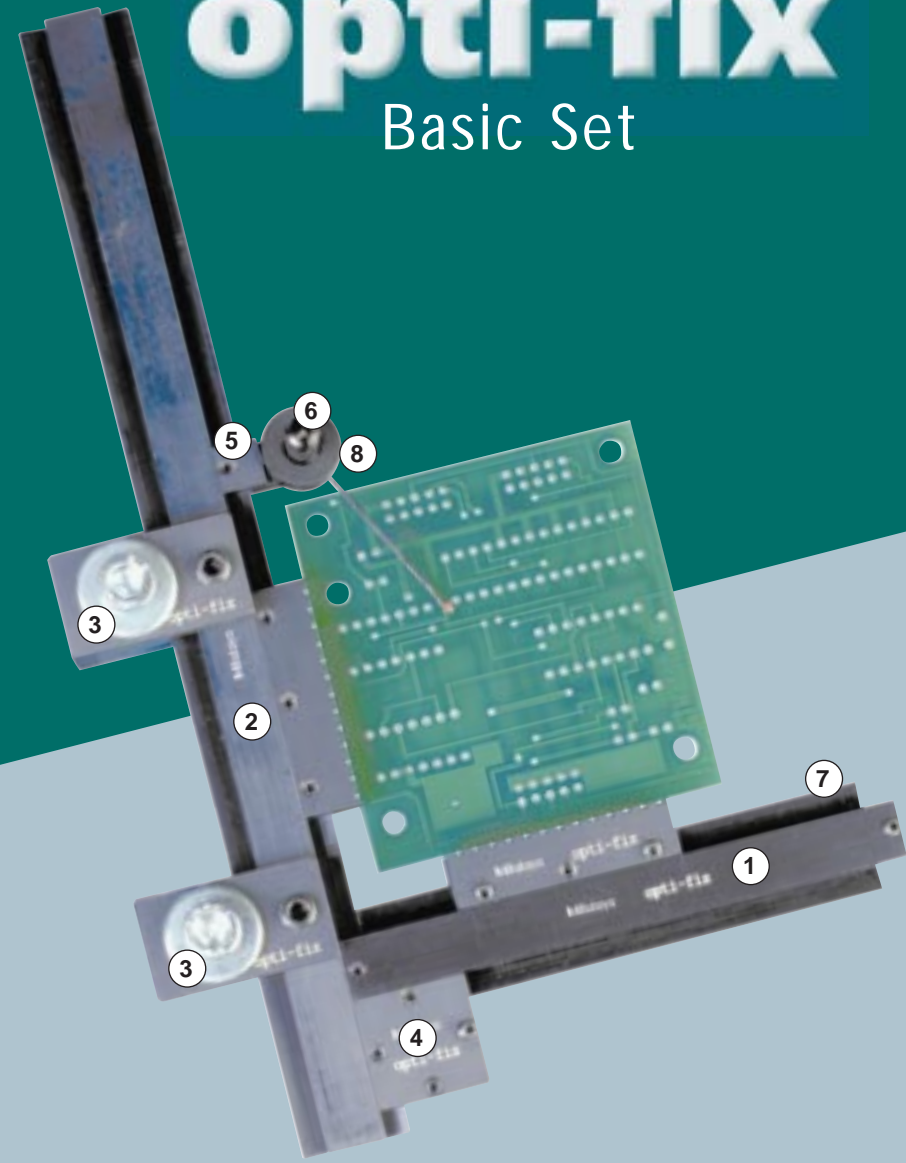

Description	Qty	Remarks
1 Shaped clamping guide with groove	1	100mm
2 Shaped clamping guide without groove	1	200mm
3 Fixing clip	2	-
4 Connector with groove	1	-
5 Clamping fixture	1	-
6 Cylindrical pin with thread	1	30mm
7 Bevel with longitudinal groove	2	40/10mm
8 Spring clip long 15 degrees	1	-

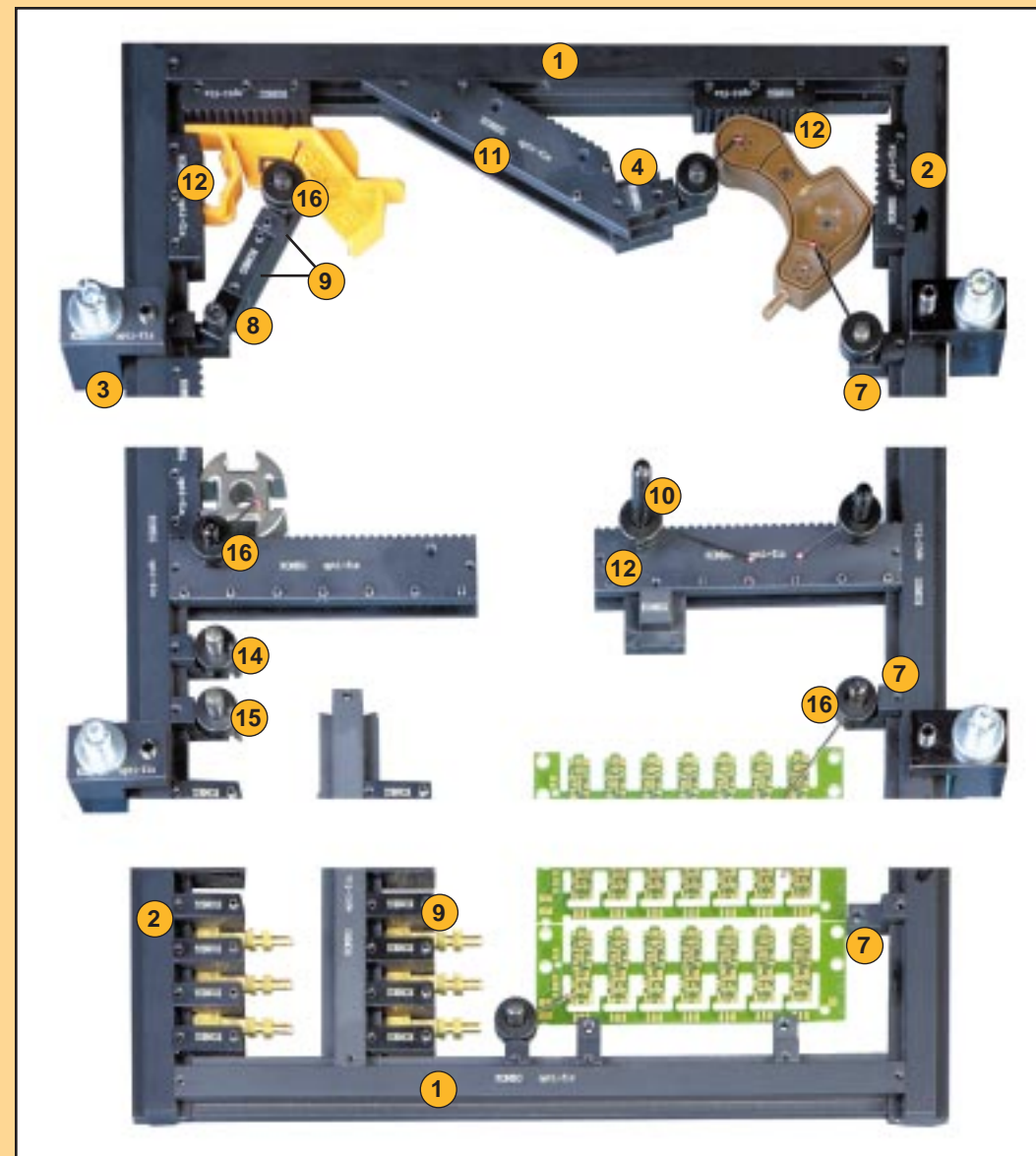
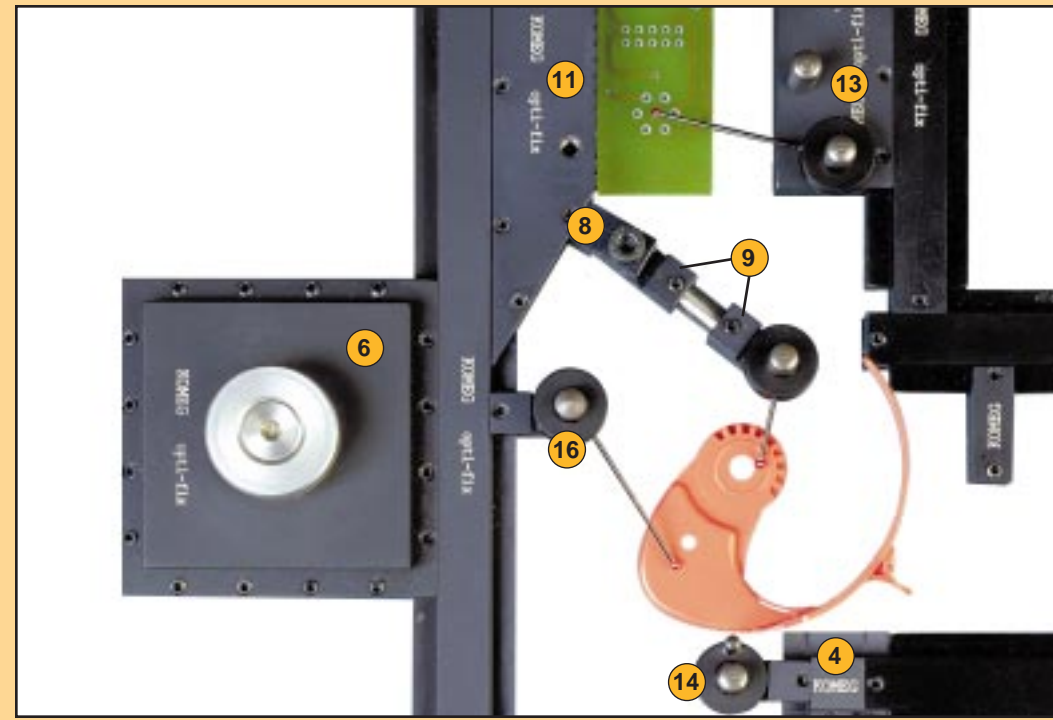

16 basic units

Lateral Clamping Bar with Frontal Attaching Groove

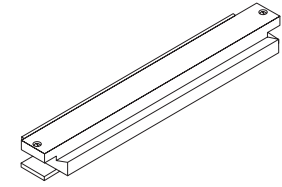

1 Other lengths upon request (adaptation to table size)

M550838	100/19.6 mm
M550859	200/19.6 mm
M550835	240/19.6 mm
M550836	250/19.6 mm

Lateral Clamping Bar Without Frontal Attaching Groove

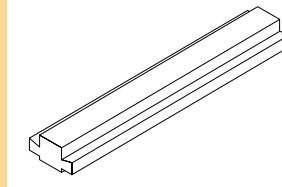

2 Other lengths upon request (adaptation to table size)

M550861	100/19.6 mm
M550857	200/19.6 mm
M550854	250/19.6 mm
M550834	310/19.6 mm

Attaching Bracket with Long Hole for Fastening Down Lateral Clamping Bar

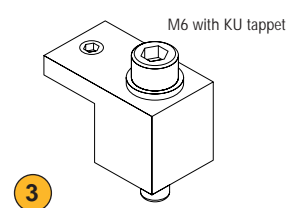

3

M550846
Other lengths upon request (adaptation to table size)

Joint with Dovetail Connection

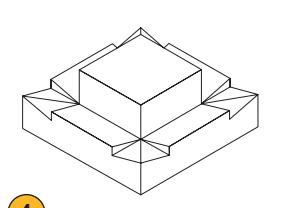

4

M550841

Joint with Connecting Grooves

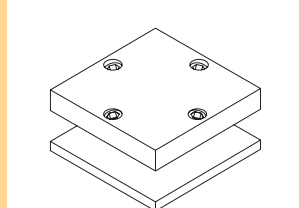

5

M550842

Suction Plate as Docking Element on the Measuring Table

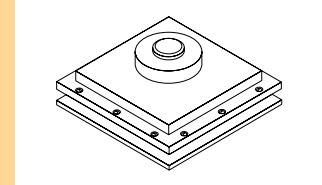

6 When there is no tap for attaching bracket

M550844

Clamp Holder with Threaded Tap

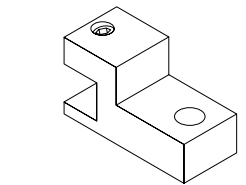

7 For use with spring clips, also usable as guide element

M550853

Joint Piece with Dovetail Connection

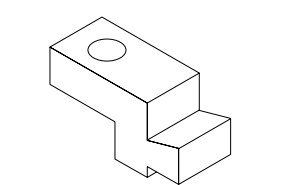

8 Used in connection with M550853

M550840

Telescoping Holder

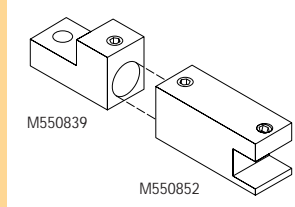

9 Used in connection with cylindrical pin without threads

end piece M550852
sliding piece M550839

Cylindrical Pins

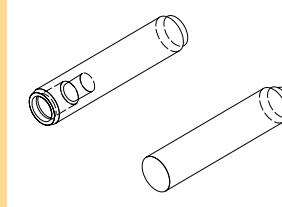

10 For telescoping holder without threads

M550887 10 mm M550888 20 mm
M550889 30 mm M550890 40 mm
M550891 30 mm
For hold-down clamp (with M4 threaded tap)

Positioning Cam 30° / 45°

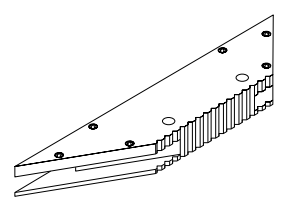

11

M550837 250/20 mm

Positioning Cam

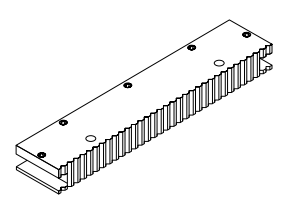

12

M550843 100/20 mm (With connecting grooves longitudinally and on the front as well as M4 threaded tap for spring clips.
M550845 40/10 mm (Only with longitudinal groove)

Holder for Spring Clips

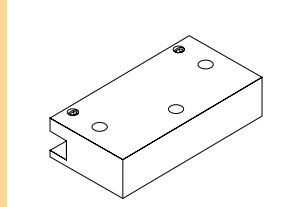

13

M550850

Swivel with Cylindrical Pin

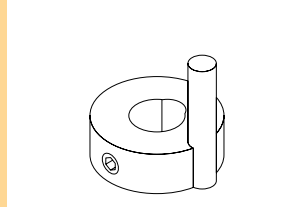

14

M550847

Swivel with Insert

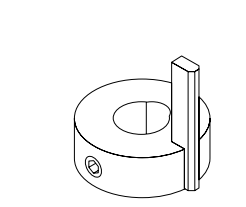

15

M550851

Spring Clip

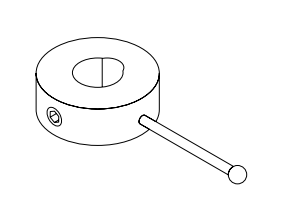

16 30° for very thin pieces
15° for thin pieces

15° M550870 (short) M550848 (short)
M550849 (long) M550869 (long)