

## Optional probes and calibration blocks

### Optional Accessories

- 12AAF712:** Battery pack
- 12AAF675:** Large capacity battery pack
- 12AAA797** Thermal printer (120V)
- 12AAA802** Thermal printing paper (10pcs.)
- 12AAA804** Cable for page printer\*\* (2m)
- 12AAA807** RS-232C cable (80" / 2m)
- 12AAA808** RS-232C cable (160" / 4m)

**12AAF666**  
ø1 ball probe

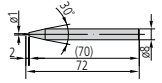

**957261**  
ø2 ball probe

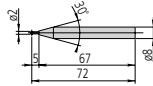

**12AAF667**  
ø2 ruby ball probe

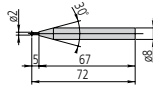

**957262**  
ø3 ball probe

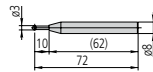

**957263**  
ø4 ball probe

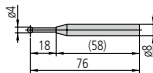

**12AAB552**  
ø10 ball probe, L=55

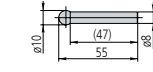

**12AAF668**  
ø10 ball probe, L=82

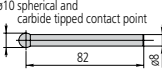

**12AAF669**  
ø10 ball probe, L=120

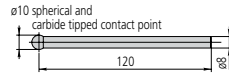

**932361** Mu-checker lever head holder  
CMM ball and disk hard probes are available.

**12AAA787** Block for calibrating probe diameter  
(applicable to taper probe)

**12AAF670**  
ø5 disk probe

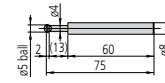

**12AAF671**  
ø10 disk probe

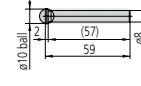

**957264**  
ø14 disk probe

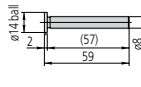

**957265**  
ø20 disk probe

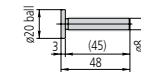

**12AAF672**  
ø1 ball offset probe\*  
\*test indicator stylus (103017)

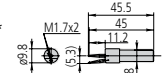

**12AAF673**  
ø2 ball offset probe

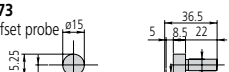

**12AAA788**  
ø4 ball offset probe

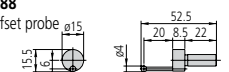

**12AAA789**  
ø6 ball offset probe

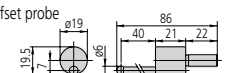

**226117**  
M2 CMM stylus adapter

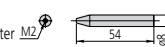

**226118**  
M3 CMM stylus adapter

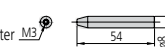

**12AAC072** Depth probe

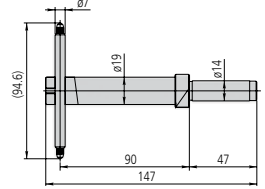

**12AAC073** ø20 taper probe

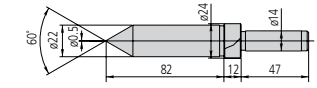

**12AAA792** Dial indicator (ø8 stem) holder

**12AAA837** Dial indicator (ø3/8" stem) holder

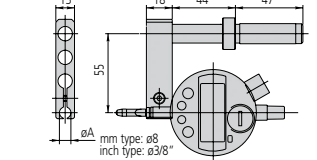

**12AAA793** Probe extension holder (85mm/3.3")

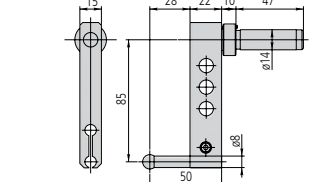

**12AAB136** ø10 cylindrical probe

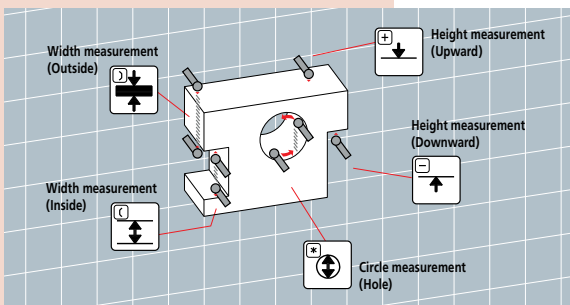
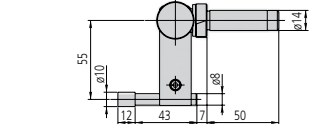

## DIMENSIONS AND MASS

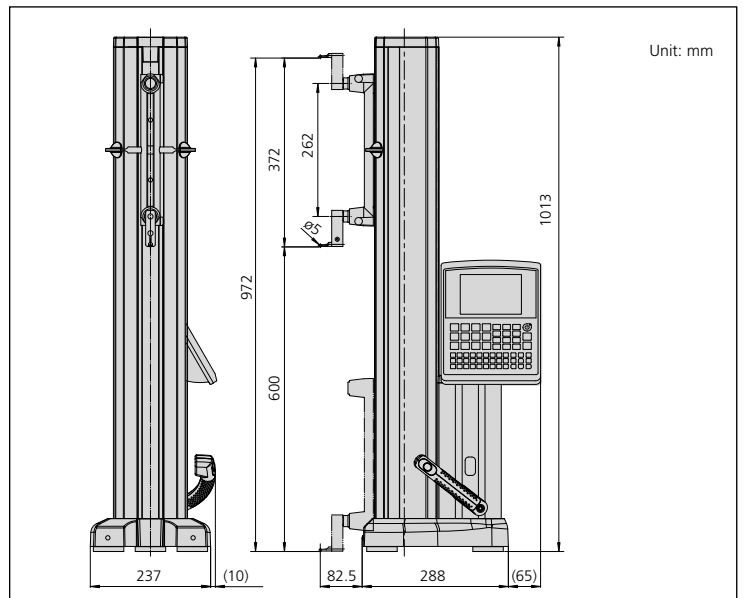

Unit: mm